

MAINTENANCE-FREE BATTERY VRLA AGM

OPTI 90Ah 12V

INDEKS: 6AKUV090AG
EAN: 5904100451517

The construction of **VRLA AGM OPTI batteries (Absorbing Glass Matt)** by VOLT Polski is based on **glass mat separators soaked in electrolyte**.

VRLA (Valve Regulated Lead Acid) means that the batteries use the **technology of self-regulating safety valves and internal gas recombination reaction**. Thanks to the valves the construction of batteries is **non-spillable and protected against the leak of electrolyte outside**. Internal technology recombination of gases eliminates the need of replenishing the electrolyte. The batteries are safe and can operate in closed offices, houses. **They have a long life and low self-discharge design**.

VRLA AGM OPTI batteries can be used in: emergency power system, alarm systems, telecommunication systems, uninterruptible power supplies, marine and medical equipment.

IMPORTANT!

Using maintenance-free **AGM batteries (e.g. AGM, AGM OPTI, AGM VPRO series) to work in photovoltaic installations (cyclic use)** may result in a **faster loss of battery efficiency and capacity**. Such batteries are **designed to float use (e.g. emergency power supply systems)**.

The same as in the case of other types of batteries, **inappropriate charging current may result in damage of the battery and loss of warranty for the battery**.

Main technical data:

Nominal voltage	12V
Nominal capacity	90Ah
Internal Resistance (25°C)	7,2mΩ
Capacity (40°C)	102%
Capacity (25°C)	100%
Capacity (0°C)	85%
Capacity (-15°C)	65%
Self discharge (25°C) 3months	91%
Self discharge (25°C) 6months	82%
Self discharge (25°C) 12months	64%
Working temperature	25°C±3°C
Working temperature - discharge	(-15 to 50)°C
Working temperature - charge	(-10 to 50)°C
Working temperature - storage	(-20 to 50)°C
Charge voltage (25°C)	14,4VDC(NORM) - 14,7VDC(BOOST)
Max charge current	21A
Max discharge current	700A (for 5 seconds)
Design life (25°C)	5-8years
Total height	214mm
Height	209mm
Width	169mm
Length	260mm
Weight	19,4kg±3%
Gross dimensions	27x18x24,7cm
Gross weight	19,8kg

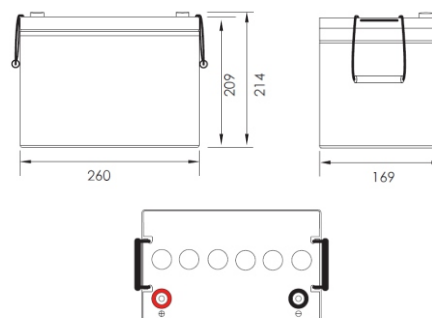

Dimensions

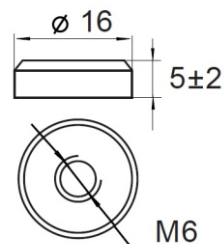

Terminal type (mm):