

PRODUCT MANUAL

HUMIDIFIER

COMFORT BREEZE

1,2L - 3,2L

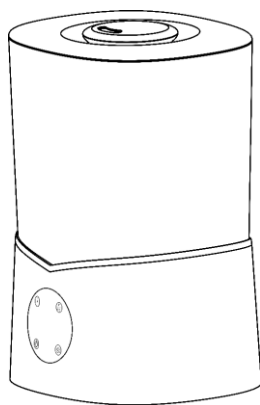

VOLT
POLSKA

VOLT POLSKA Sp. z o.o.
ul. Bitwy pod Płowcami 76
81-771 Sopot
www.voltpolska.pl

Thank you for purchasing the **humidifier BREEZE COMFORT (1,2L & 3,2L)** by **VOLT Polska**. Please read this user manual before starting the device.

WARNING: TO AVOID THE RISK OF ELECTRICAL SHOCK, ALWAYS MAKE SURE THE PRODUCT IS UNPLUGGED FROM THE ELECTRICAL OUTLET BEFORE ASSEMBLING, DISASSEMBLING, RELOCATING, SERVICING, OR CLEANING IT.

1. In order to make better use of this machine, first read the instructions carefully.
2. Do not unauthorized demolition, repair, alteration, the electrical appliances.
3. If the supply cord is damaged, it must be replaced by the manufacturer, its service department, or other similar personnel in order to avoid danger.
4. Clean or move , please turn off the power and unplug the plug.
- 5 . Do not turn on the electrical state in the electrical to avoid burning the internal electronic components.
6. The work of the machine, please put the child cannot touch the range.
7. The work of the machine, not touch the sink in the various components.
8. Do not pull the power cord unplug the power plug or wet hands touch the power plug.
9. This machine can only be used for indoor use.
10. The power cord do not bend or heavy pressure.
11. Thunderstorms or long – term, do not pull out the power plug.
12. Adults need to supervise children to ensure that children do not play with the machine.
13. Please place in a flat and solid place, avoid tilt.
14. Do not add in the water is not the company production, supervision or to allow the addition of substances.
15. Do not use the company's production, supervision or permission to use the material clean appliances.
16. Please keep away from heat sources, avoid direct sunlight and try to stay away from furniture, household appliances to avoid damp.
17. Do not in the electrical outlet and electrical appliances below the books and towels and other items placed.
18. Please use at normal room temperature (temperature 5 ~40 °C, relative humidity < 80 % RH).
19. Do not move the product while working or when there is water in the sink.
20. Cleaning to avoid water within the product failure.

OVERVIEW THE HUMIDIFIER

1. Water Lid
2. LED Display
3. Power (ON/OFF)
4. Timer
5. LED Lighting
6. Misting

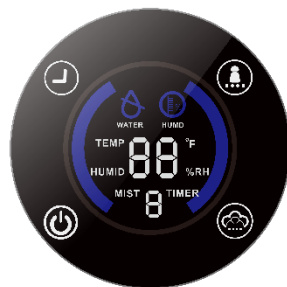
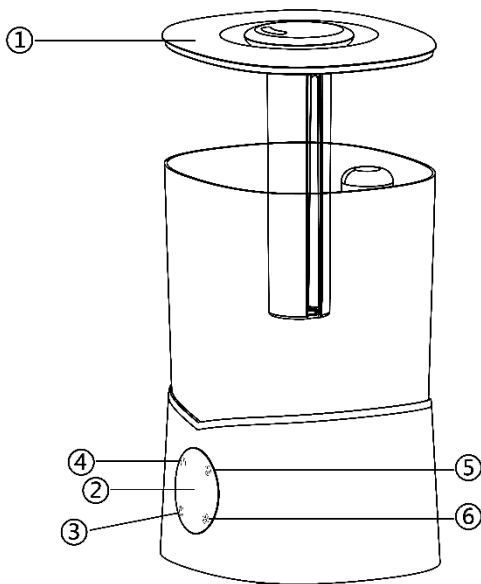

Technical Parameters

Operation

1. Open the water lid (1) of the humidifier and fill with tap water and purified water.
2. Press the on-/off-button(3) on the control panel to start the appliance. The environmental temperature in °C and the current relative air humidity in % are shown on the LED display(2).
3. Press the Mist button (6) to choose the desired Mist speed speed.
4. Press the Timer Button (4) to select the desired runtime. This is possible to set "2H", "4H", "6" or "8H".
5. Press the LED lighting button(5), there are different color changes. (The actual color shall prevail).

Make the water tank empty:

If you do not use it for a long time, pick up the cover, keep the tank tilted in line with the base, please empty the water from the tank to avoid odor.

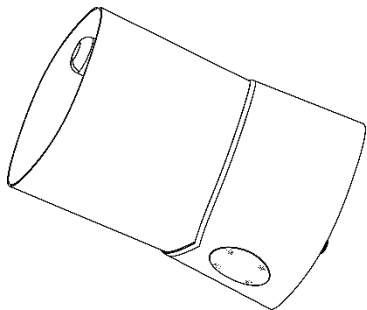
**CLEANING AND MAINTENANCE**

NOTED: Before cleaning the appliance always disconnect the power plug from the receptacle.

1. DO NOT dip the device in water, or splash it with any other liquids.
2. DO NOT use solvents or any other chemical products for cleaning it. When you do not use it, after cleaning it, store the fan in a dry place.
3. When you have finished using the fan at the end of the season, wipe off any dust to maintain it in good working order for the next season; if necessary disassemble the grille and remove the fan; clean them with a soft damp cloth.
4. Remove the water tank and clean it with lukewarm water; before replace the water tank in the unit make sure it is completely dry.

SPECIFICATION

POWER: 25W (1,2L); 25W (3,1L)
VOLTAGE: 100-240V~ 50Hz
DIMESION: 148/131/278mm

Failure inspection and elimination method

If your humidifier does not work, please before request maintenance service for the following inspection.

The fault phenomenon	Cause analysis	Method of exclusion
The indicator light is not displayed	1.Power is not connected 2.The power switch is not open	1. Turn on the power 2. Turn on the power switch
Indicator light, with the wind, no fog	The fog volume is set to the minimum level	Set to the desired fog position
Spray a small amount	1. For energy - chip scale 2. Dirty water or water storage time is long 3. Low water temperature 4. Fog volume set at the minimum gear	1. Cleaning - for - chip 2. Add a small amount of hot water to the sink 3. The replacement of clean water 4. Set to the required fog
Fog spills from the tank cover or around the nozzle	1. The tank cover and tank with a gap 2. Nozzle and tank cover with a gap	1. Remove the tank cover, back cover 2. The nozzle with wetting
Abnormal noise	1. Less water, causing resonance 2. Place the table to resonate	1. Add water to the tank 2. Placed in a firm and stable surface
Indicator light , water tank, but always show the status of water (red)	The float is jammed	Pull the float, let the activities from top to bottom smooth

WARRANTY CARD

DATA OF PURCHASE	
SHIPPING ADDRESS	
SIGNATURE/STAMP	
DAMAGE DESCRIPTION	
SERVICE COMMENTS	

FILL IN IF NEEDED

(*) Cross incorrect

I agree to pay the cost of inverter repair due to:

* expiration of the warranty period / * warranty void

Before proceeding with the repair, service will inform by phone
about the exact costs of the repair.

Please attach a copy of the purchase document (receipt or invoice)
to the complaint.

The full regulations of service repairs can be found on our website
www.voltpolska.pl

