

# MAINTENANCE-FREE BATTERY VRLA AGM

## OPTI 65Ah 12V

INDEKS: 6AKUV065AG  
EAN: 5904100450374

The construction of **VRLA AGM OPTI batteries (Absorbing Glass Matt)** by VOLT Polski is based on **glass mat separators soaked in electrolyte**.

**VRLA (Valve Regulated Lead Acid)** means that the batteries use the **technology of self-regulating safety valves and internal gas recombination reaction**. Thanks to the valves the construction of batteries is **non-spillable and protected against the leak of electrolyte outside**. Internal technology recombination of gases eliminates the need of replenishing the electrolyte. The batteries are safe and can operate in closed offices, houses. **They have a long life and low self-discharge design**.

**VRLA AGM OPTI** batteries can be used in: emergency power system, alarm systems, telecommunication systems, uninterruptible power supplies, marine and medical equipment.

### IMPORTANT!

Using maintenance-free **AGM batteries (e.g. AGM, AGM OPTI, AGM VPRO series)** to work in photovoltaic installations (cyclic use) may result in a **faster loss of battery efficiency and capacity**. Such batteries are **designed to float use (e.g. emergency power supply systems)**.

The same as in the case of other types of batteries, **inappropriate charging current may result in damage of the battery and loss of warranty for the battery**.

### Main technical data:

Nominal voltage	12V
Nominal capacity	65Ah
Internal Resistance (25°C)	7,2Ω
Capacity (40°C)	102%
Capacity (25°C)	100%
Capacity (0°C)	85%
Capacity (-15°C)	65%
Self discharge (25°C) 3months	91%
Self discharge (25°C) 6months	82%
Self discharge (25°C) 12months	64%
Working temperature	25°C±3°C
Working temperature - discharge	(-15 to 50)°C
Working temperature - charge	(-10 to 50)°C
Working temperature - storage	(-20 to 50)°C
Charge voltage (25°C)	14,4VDC(NORM) - 14,7VDC(BOOST)
Max charge current	19,5A
Max discharge current	400A (for 5 seconds)
Design life (25°C)	5-8years
Total height	176mm
Height	176mm
Width	167mm
Length	347mm
Weight	18,4kg±3%
Gross dimensions	36x17,4x20,5cm
Gross weight	81,1kg

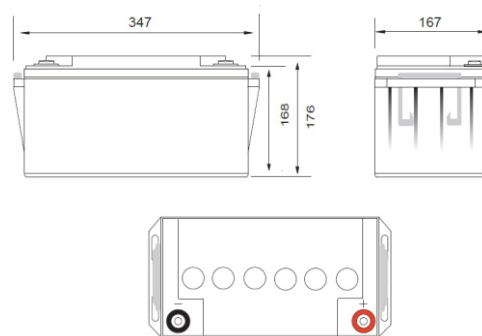

Dimensions

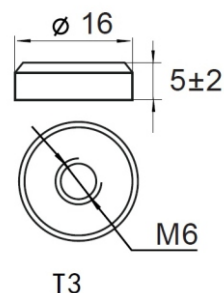

Terminal type (mm):